

C. & D down the Ck

5° 51' E. 48 P^s

N° 68 E. 40 D°

N° 15 E. 61 D°

5° 69 E. 90 D°

North 46½ D°

N° 50 W. 119 D° to the Hill 19 P^s

from y^e Ck

404½

19

385½ along y^e Ck

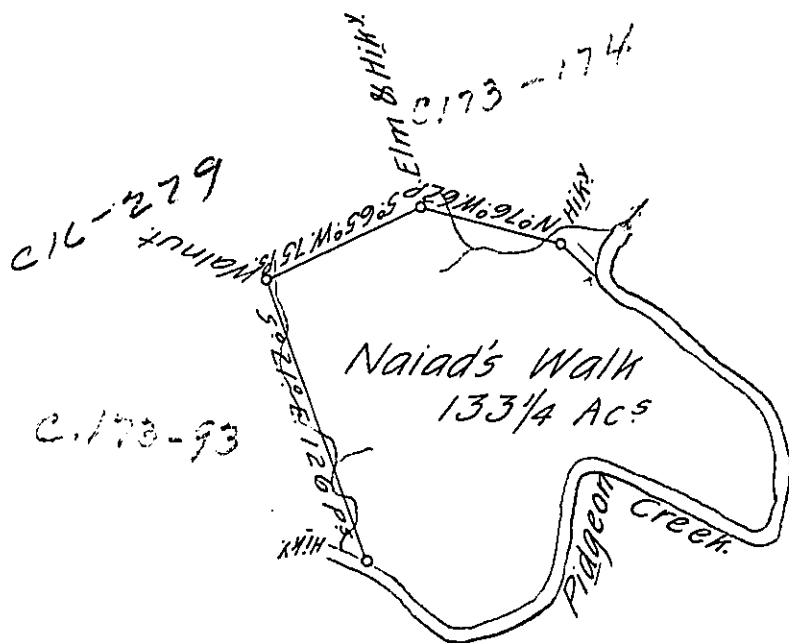

A Draught of a Survey call'd "Naiad's Walk," lying on Pidgeon Ck in Washington County, cont^g 133¼ Ac^s with the usual Allow^{ce} for Highways &c, executed Nov^r ye 19th 1785, in Pursuance of a Warrant for 162 Ac^s in the Name of Joseph Platter dated Ap^l 11th 1785.

Jn^o Lukens, Esqr. 5^r Gen^l

Presley Nevill. } D. 5s.
Matt^w Ritchie. }

IN TESTIMONY that the above is a copy of the original remaining on file in the Department of Internal Affairs of Pennsylvania, made conformably to an Act of Assembly approved the 16th day of February, 1833, I have hereunto set my Hand and caused the Seal of said Department to be affixed at Harrisburg, this first day of June 1906.

Geac D. Brown
Secretary of Internal Affairs.